

MBR0520L

SCHOTTKY BARRIER RECTIFIERS

0.5AMPERES 20 VOLTS

Surface Mount Schottky Power Rectifier

Description

This Schottky Power Rectifier employs the Schottky Barrier principle with a barrier metal that produces optimal forward voltage drop – reverse current tradeoff. Ideally suited for low voltage, high frequency rectification, or as free wheeling and polarity protection diodes in surface mount applications where compact size and weight are critical to the system.

Features

- Guarding for stress protection
- Very low forward voltage (0.38V Max @ 0.5A, 25°)
- 125° Operating junction temperature
- Package designed for optimal automated board assembly

Mechanical Characteristics

- Polarity designator: cathode band
- Case: epoxy, molded
- Finish: all external surfaces corrosion resistant and terminal leads are readily solderable
- Lead and mounting surface temperature for soldering purposes: 260° Max. for 10 seconds

Absolute Maximum Ratings (Ta = 25 °C)

Parameter	Symbol	Limits	Unit
DC Blocking Voltage	V_R	20	V
Peak Repetitive Reverse Voltage	V_{RRM}	20	V
Working Peak Reverse Voltage	V_{RWM}	20	V
Average Rectified Forward Current @ Rated V_R , $T_L = 90^\circ$	$I_{F(AV)}$	0.5	A
Non-Repetitive Peak Surge Current. (Surge applied at rated load conditions halfwave, single phase, 60Hz)	I_{FSM}	5.5	A
Thermal Resistance Junction to Lead	$R_{\theta JL}$	150	? /W
Thermal Resistance Junction to Ambient (Note 1)	$R_{\theta JA}$	206	? /W
Operating Junction Temperature	T_J	-65 to +125	°
Storage Temperature	T_{stg}	-65 to +125	°

1) 1 inch square pad size (1x 0.5 inch for each lead) on FR4 board

PINNING

PIN	DESCRIPTION
1	Cathode
2	Anode

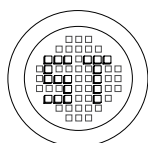
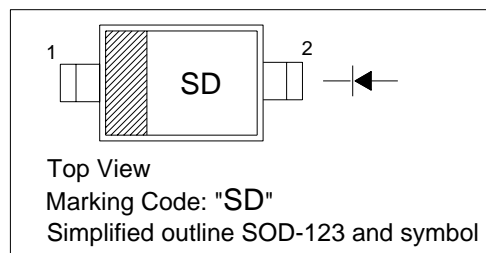

®

РАДИОТЕХ-ТРЕЙД

Тел.: (495) 795-0805
Факс: (495) 234-1603
Эл. почта: info@rct.ru
Веб: www.rct.ru

MBR0520L

Electrical Characteristics (Ta = 25°C)

Parameter	Symbol	Min	Typ	Max	Unit	Conditions
Instantaneous Forward Voltage (Note 2.)	V _F	-	-	0.300	V	I _F = 0.1A, T _J = 25°C
		-	-	0.385	V	I _F = 0.5A, T _J = 25°C
		-	-	0.220	V	I _F = 0.1A, T _J = 100°C
		-	-	0.330	V	I _F = 0.5A, T _J = 100°C
Instantaneous Reverse Current (Note 2)	I _R	-	-	250	uA	Rated DC voltage = 20V, T _J = 25°C
		-	-	8	mA	Rated DC voltage = 20V, T _J = 100°C
		-	-	75	uA	V _R = 10V, T _J = 25°C
		-	-	5	mA	V _R = 10V, T _J = 100°C
Voltage Rate of Change (Rated V _R)	d _v / d _t	-	-	1000	V/us	-

1) Pulse test: pulse width < 300us, duty cycle ≤ 2%.

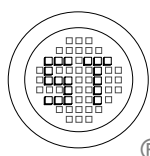

SEMTECH ELECTRONICS LTD.

(Subsidiary of Semtech International Holdings Limited, a company listed on the Hong Kong Stock Exchange, Stock Code: 724)

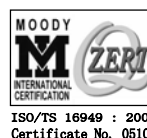

Dated : 22/07/2004

MBR0520L

PACKAGE OUTLINE

Plastic surface mounted package; 2 leads

SOD-123

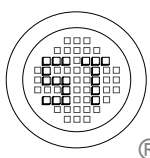
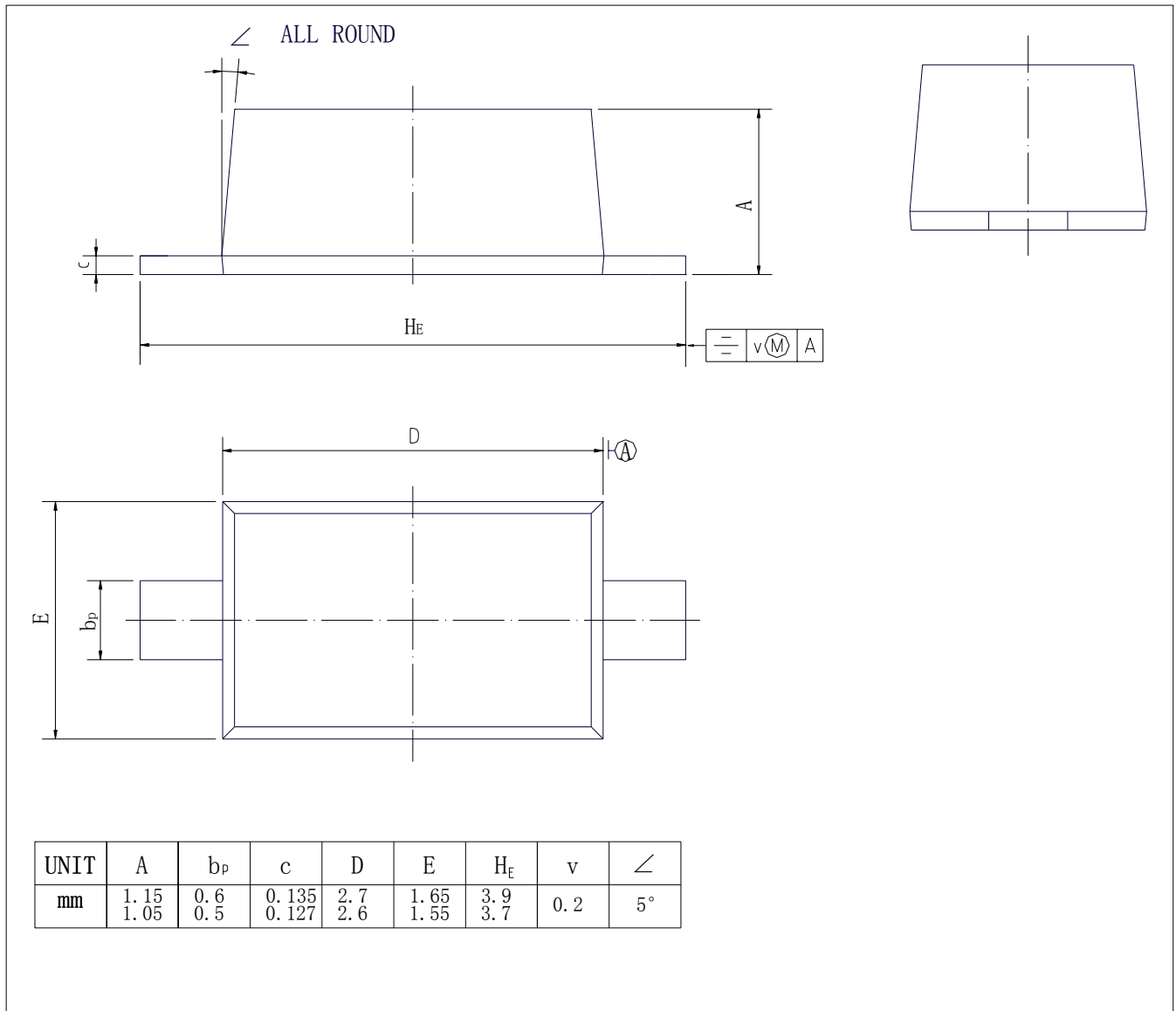

SEMTECH ELECTRONICS LTD.

(Subsidiary of Semtech International Holdings Limited, a company listed on the Hong Kong Stock Exchange, Stock Code: 724)

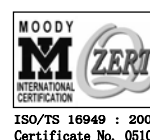

ISO/TS 16949 : 2002
Certificate No. 05103



ISO 14001
Certificate No. 7116



ISO 9001 : 2000
Certificate No. 828-100-0102-001

Dated : 22/07/2004