

1SS356WS

BAND SWITCHING DIODE

FEATURES

- Small surface mounted type.
- High reliability .

APPLICATIONS

- High frequency switching

PINNING

PIN	DESCRIPTION
1	Cathode
2	Anode

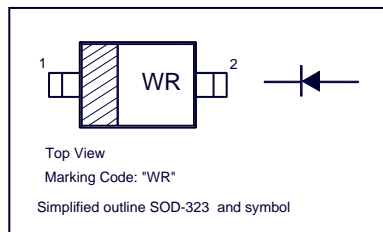

Absolute Maximum Ratings ($T_a = 25\text{ }^{\circ}\text{C}$)

Parameter	Symbol	Limits	Unit
DC reverse voltage	V_R	35	V
DC forward current	I_o	100	mA
Junction temperature	T_J	125	$^{\circ}\text{C}$
Storage temperature	T_{stg}	-55 ... +125	$^{\circ}\text{C}$

Electrical Characteristics ($T_a = 25\text{ }^{\circ}\text{C}$)

Parameter	Symbol	Min	Typ	Max	Unit	Conditions
Forward voltage	V_F	-	-	1.0	V	$I_F = 10\text{mA}$
Reverse current	I_R	-	-	10	nA	$V_R = 25\text{V}$
Capacitance between terminals	C_T	-	-	1.2	pF	$V_R = 6\text{V}, f = 1\text{MHz}$
Forward operating resistance	r_F	-	-	0.9	Ω	$I_F = 2\text{mA}, f = 100\text{MHz}$

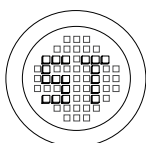

®

РАДИОТЕХ-ТРЕЙД

Тел.: (495) 795-0805
Факс: (495) 234-1603
Эл. почта: info@rct.ru
Веб: www.rct.ru

● Electrical characteristic curves (Ta=25°C)

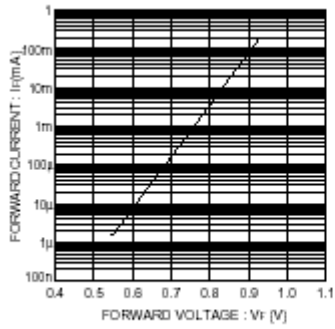

Fig. 1 Forward characteristics

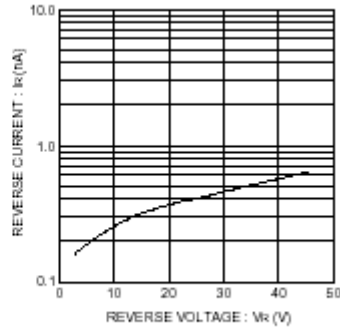

Fig. 2 Reverse characteristics

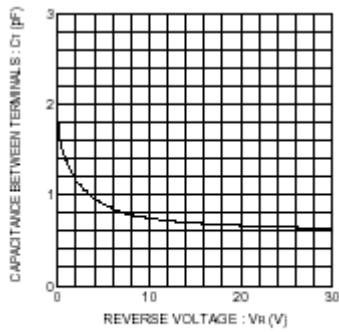

Fig. 3 Capacitance between terminals characteristics

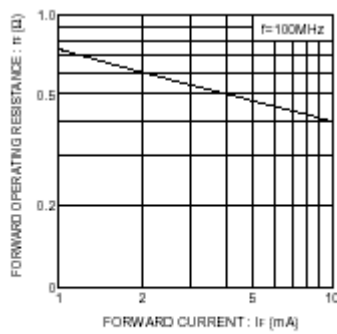
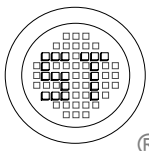

Fig. 4 Forward operating resistance characteristics



SEMTECH ELECTRONICS LTD.

(Subsidiary of Semtech International Holdings Limited, a company listed on the Hong Kong Stock Exchange, Stock Code: 724)



ISO/TS 16949 : 2002
Certificate No. 05103



ISO 14001
Certificate No. 7116



ISO 9001 : 2000
Certificate No. 550-1559-04-NL-04

1SS356WS

PACKAGE OUTLINE

Plastic surface mounted package; 2 leads

SOD-323

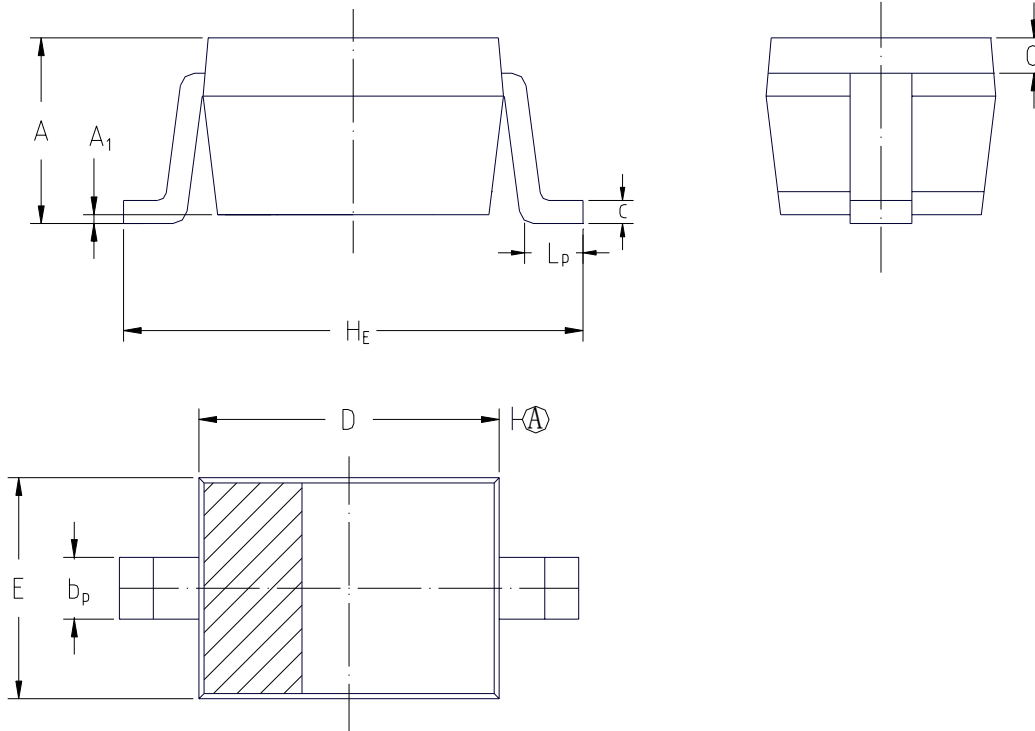

UNIT	A	A ₁	b _p	c	D	E	H _E	L _p	Q
mm	1.10 0.80	0.1 0	0.40 0.25	0.15 0.00	1.80 1.60	1.35 1.15	2.80 2.30	0.50 0.10	0.15 REF.

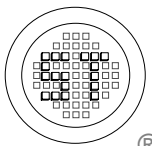

SEMTECH ELECTRONICS LTD.

(Subsidiary of Semtech International Holdings Limited, a company listed on the Hong Kong Stock Exchange, Stock Code: 724)



ISO/TS 16949 : 2002
Certificate No. 05103



ISO 14001
Certificate No. 7116



ISO 9001 : 2000
Certificate No. 550-1559-04-002-04

Dated : 31/01/2005