

# 1N4448W

## SILICON EPITAXIAL PLANAR DIODE

Fast switching diode

### PINNING

PIN	DESCRIPTION
1	Cathode
2	Anode

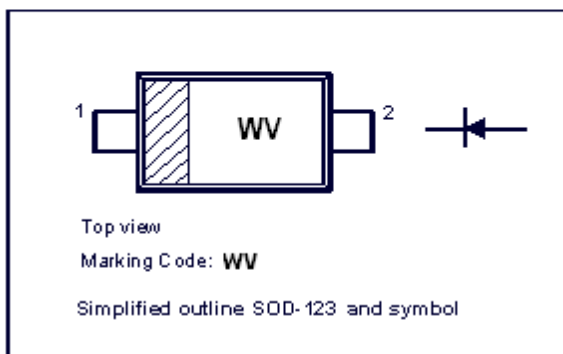

### Absolute Maximum Ratings ( $T_a = 25^\circ\text{C}$ )

	Symbol	Value	Unit
Reverse Voltage	$V_R$	75	V
Peak Reverse Voltage	$V_{RM}$	100	V
Rectified Current (Average) Half Wave Rectification with Resist. Load at $T_{amb} = 25^\circ\text{C}$ and $f/50\text{ Hz}$	$I_O$	150	mA
Surge Forward Current at $t < 1\text{s}$ and $T_j = 25^\circ\text{C}$	$I_{FSM}$	500	mA
Power Dissipation	$P_{tot}$	500	mW
Junction Temperature	$T_j$	175	?
Storage Temperature Range	$T_s$	-65 to +175	?

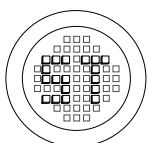

®

РАДИОТЕХ-ТРЕЙД

Тел.: (495) 795-0805  
Факс: (495) 234-1603  
Эл. почта: info@rct.ru  
Веб: www.rct.ru

# 1N4448W

## Characteristics at $T_j = 25^\circ\text{C}$

	Symbol	Min.	Typ.	Max.	Unit
Forward Voltage at $I_F = 5\text{mA}$ at $I_F = 10\text{mA}$	$V_F$	0.62	-	0.72	V
	$V_F$	-	-	1	V
Leakage Current at $V_R = 20\text{V}$ at $V_R = 75\text{V}$ at $V_R = 20\text{V}, T_j = 150^\circ\text{C}$	$I_R$	-	-	25	nA
	$I_R$	-	-	5	$\mu\text{A}$
	$I_R$	-	-	50	$\mu\text{A}$
Reverse Breakdown Voltage tested with $100\mu\text{A}$ Pulses	$V_{(BR)R}$	100	-	-	V
Capacitance at $V_F = V_R = 0$	$C_{\text{tot}}$	-	-	4	pF
Reverse Recovery Time from $I_F = 10\text{mA}$ to $I_R = 1\text{mA}$ , $V_R = 6\text{V}$ , $R_L = 100\Omega$	$t_{rr}$	-	-	4	ns
Thermal Resistance Junction to Ambient Air	$R_{\text{thJA}}$	-	-	350	K/W
Rectification Efficiency at $f = 100\text{MHz}$ , $V_{RF} = 2\text{V}$	$\eta_v$	0.45	-	-	-

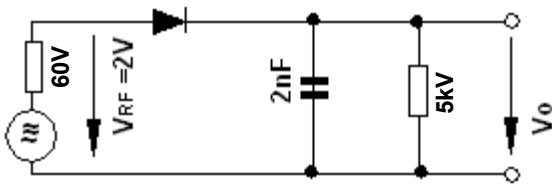

Rectification Efficiency Measurement Circuit

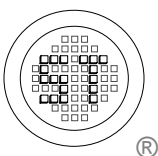

## SEMTECH ELECTRONICS LTD.

(Subsidiary of Semtech International Holdings Limited, a company listed on the Hong Kong Stock Exchange, Stock Code: 724)



ISO/TS 16949 : 2002  
Certificate No. 05103



ISO 14001  
Certificate No. 7116



ISO 9001 : 2000  
Certificate No. 555-196-01-00-104

Dated : 16/04/2005 G

# 1N4448W

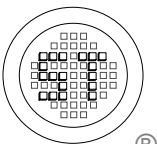
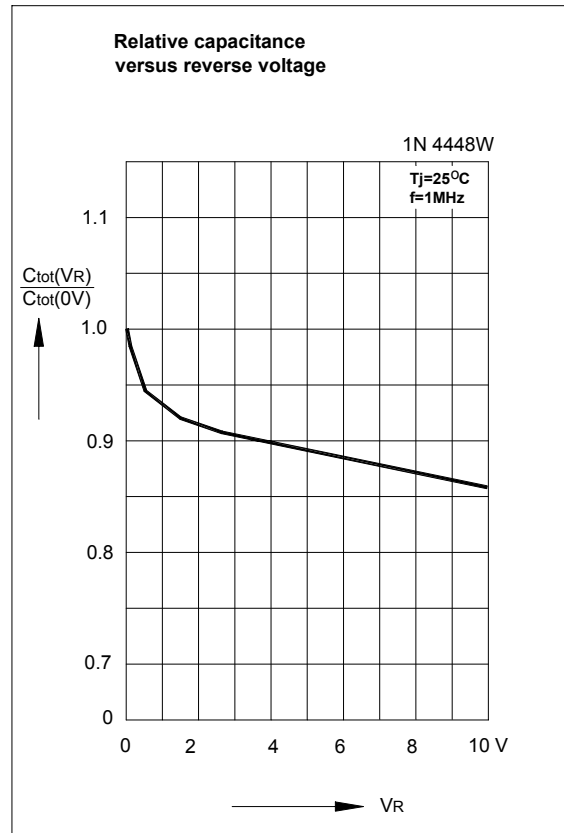
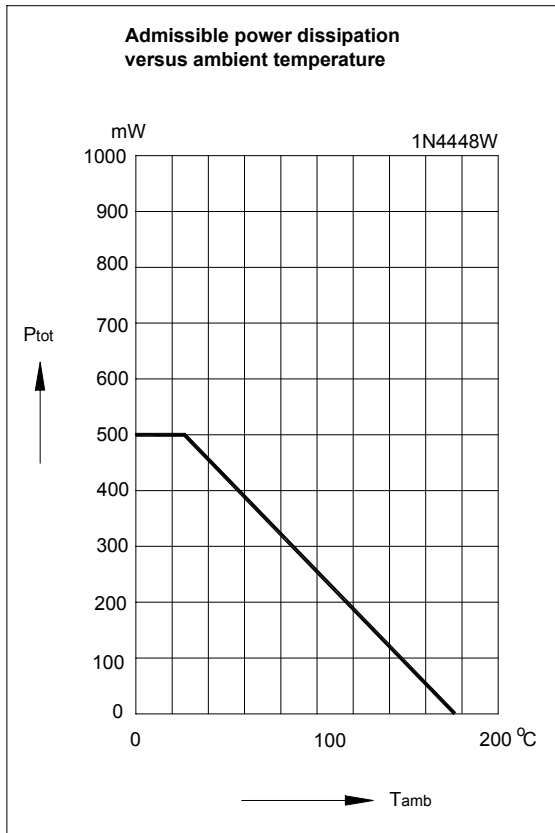
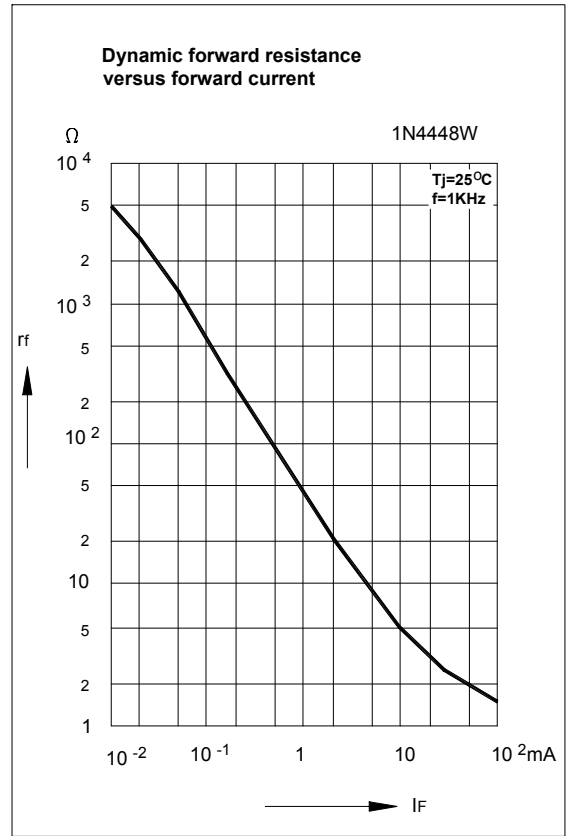
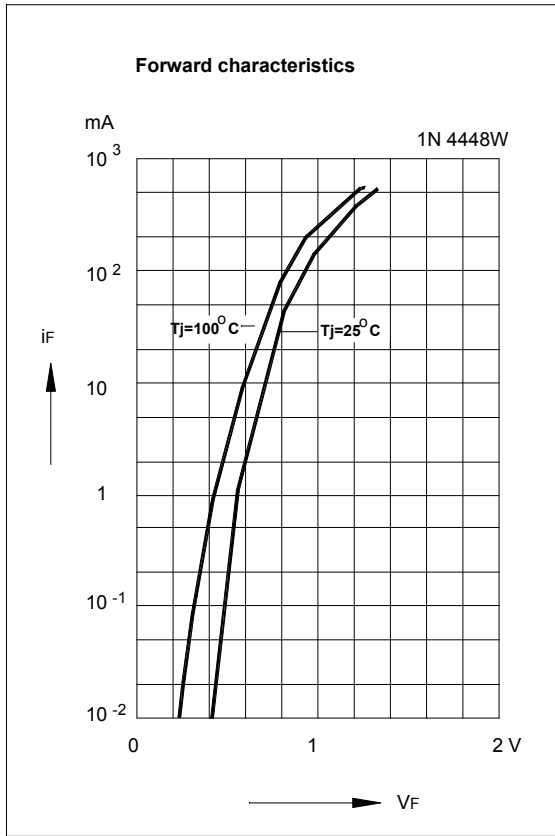

**SEMTECH ELECTRONICS LTD.**

(Subsidiary of Semtech International Holdings Limited, a company listed on the Hong Kong Stock Exchange, Stock Code: 724)



ISO/TS 16949 : 2002  
Certificate No. 05103



ISO 14001  
Certificate No. 7116



ISO 9001 : 2000  
Certificate No. 555-196-01-90-104

Dated : 16/04/2005 G

# 1N4448W

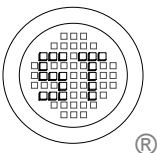
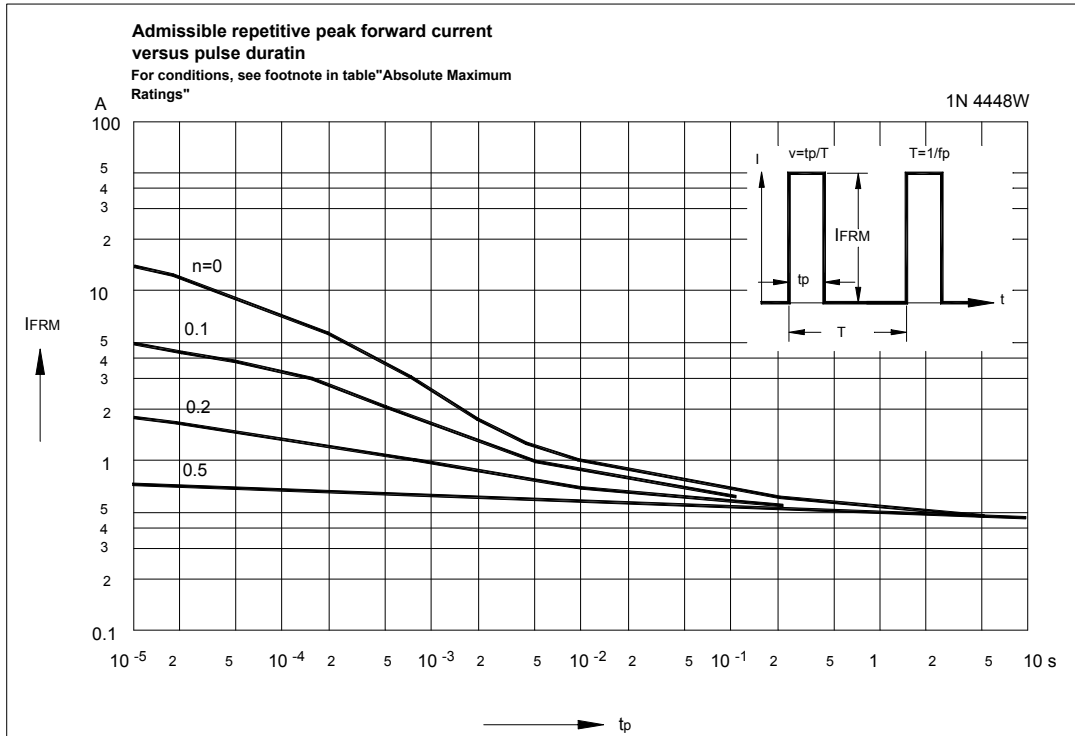
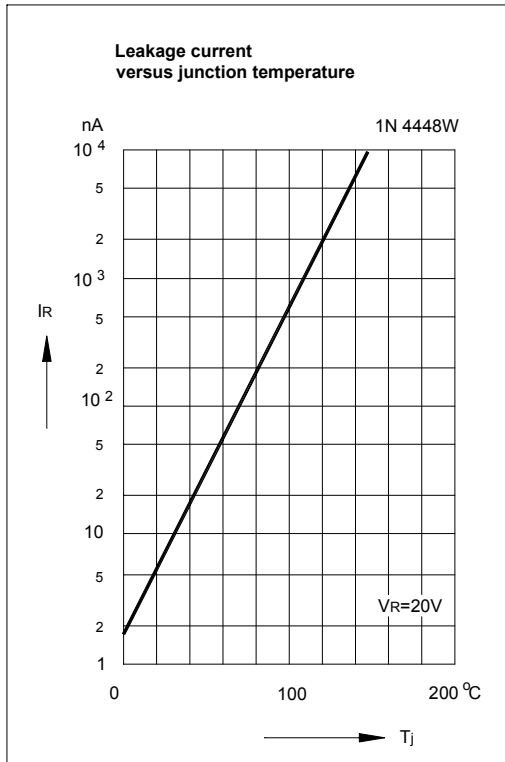

## SEMTECH ELECTRONICS LTD.

(Subsidiary of Semtech International Holdings Limited, a company listed on the Hong Kong Stock Exchange, Stock Code: 724)



ISO/TS 16949 : 2002  
Certificate No. 05103



ISO 14001  
Certificate No. 7116



ISO 9001 : 2000  
Certificate No. 555-199-01-00-104

# 1N4448W

## PACKAGE OUTLINE

Plastic surface mounted package; 2 leads

SOD-123

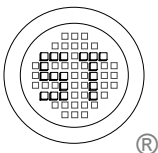
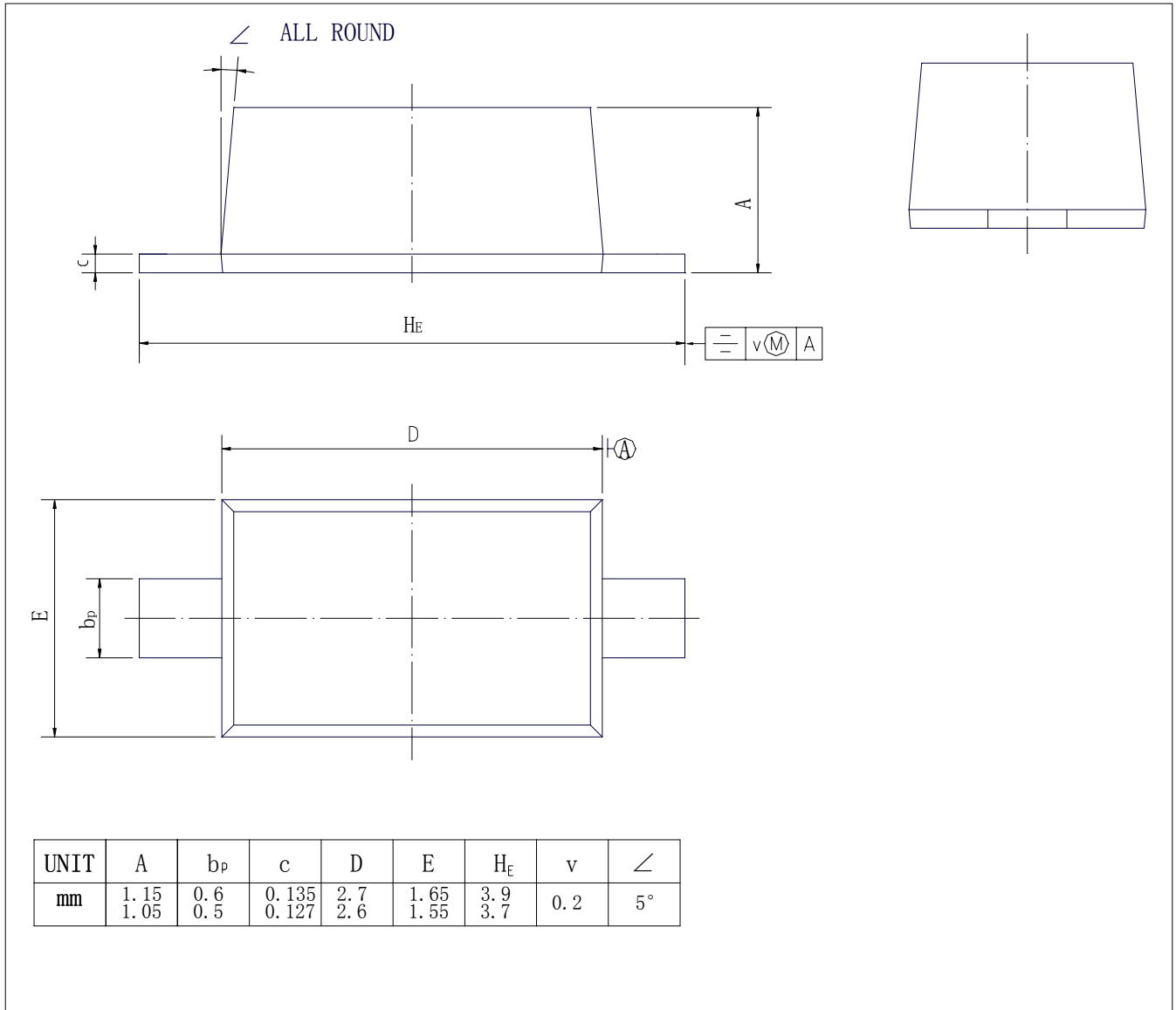

**SEMTECH ELECTRONICS LTD.**

(Subsidiary of Semtech International Holdings Limited, a company listed on the Hong Kong Stock Exchange, Stock Code: 724)



ISO/TS 16949 : 2002  
Certificate No. 05103



ISO 14001  
Certificate No. 7116



ISO 9001 : 2000  
Certificate No. 555-196-01-007-104

Dated : 16/04/2005 G